

Solenoid Valves



4V Series Solenoid Valve, 4A Series Pneumatic Control Valve

4V210-08



4A210-08



4V120-06



4A220-08



4V220-08



Ordering Code

4V	2	10	06	□	AC220V	W
Specification Code 4V: Two(Three)-position Five-way Solenoid Valve 4A: Two (Three)-position Five-way Pneumatic Control Valve	Body Size 1: M5 and 1/8" Valve body 2: 1/8" and 1/4" Valve body 3: 1/4" and 3/8" Valve body 4: 1/2" Valve body	Coil and Places 10: Single-head Double-position 20: Double-head Double-position 30C: Double-head Three-position Close Type 30E: Double-head Three-position Exhaust Type 30P: Double-head Three-position Pressure Type	Port Size M5: M5×0.8 06: G1/8" 08: G1/4" 10: G3/8" 15: G2"	Port connection and Initial State Blank: Pipe Connection Type NC: Two-position Three-way Normal Close Type NO: Two-position Three-way Normal Open Type	Standard Voltage DC12V DC24V AC24V 50Hz/60Hz AC110V 50Hz/60Hz AC220V 50Hz/60Hz AC380V 50Hz/60Hz	Wiring Form Blank: standard Connector LD: Brown with Lighting Connector LD1: White with Lighting Connector W: Lead Wire Type

Internal Structure

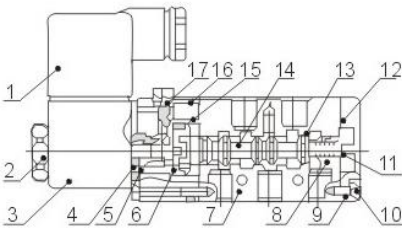

4V110~410

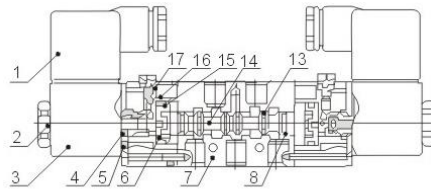

4V120~420

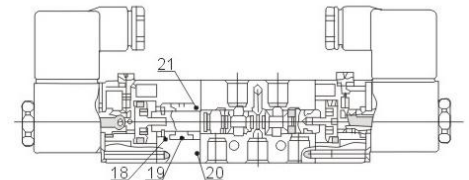

4V130~430

NO	Designation	NO	Designation	NO	Designation	NO	Designation	NO	Designation	NO	Designation	NO	Designation
1	Connector	4	Active Amature	7	Body	10	Screw	13	O-Ring	16	Spring	19	Spring
2	Nut	5	Steel Part	8	Steel Part	11	Spring	14	Spool	17	Pin	20	Side Cover
3	Coil	6	Piston	9	End Cap	12	Seal ring	15	O-Ring	18	Spring Seat	21	Spring Seat

Specification

Model	4V110~410	4V120~420	4V130~430C/P/E
	4A110~410		4A130~430C/P/E
Position and Way NO.	Two-position Five-way		Three-position Five-way
Working Medium	40 Micron Filtered Air		
Motion Pattern	Inner Guide Type		
Working-Pressure	0.15~0.8Mpa (22psi ~116psi)		
Max. Pressure Resistance	1.2Mpa (174psi)		
Operating Temperature	5~50°C		
Voltage Range	±10%		
Power Consumption	AC:4.5VA DC:3W		
Insulation & Protection Class	F Class. IP65		
Electrical entry	Lead Wire or Connector type		
Highest Action Frequency	5 Cycle / Second		
Response time	0.05 Second		

Overall Dimensions

4V110-410

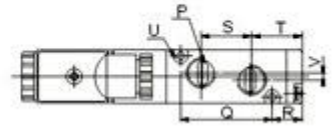
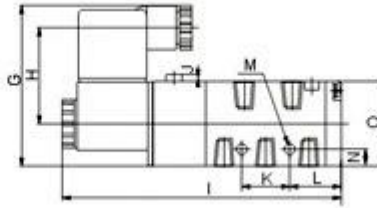
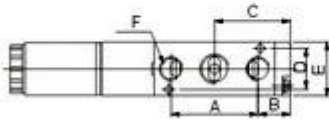
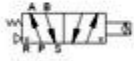

Dimension Sheet

Model	A	B	C	D	E	F	G	H	I	J	K	L	M	N	O	P	Q	R	S	T	U	V
4V110-M5	27	14.5	28	13	18	5-M5x0.8	53.5	32.5	98	2.5	14	21	2-Φ3.3	4	27	2-Φ3.3	30	13	14	21	/	/
4V110-06	28	14	28	13	18	5-G1/8"	53.5	32.5	98	2.5	14	21	2-Φ3.3	4	27	2-Φ3.3	30	13	14	21	2	3
4V210-06	36	13.5	31.5	17	22	5-G1/8"	66.5	40	116.5	3	20	21.5	2-Φ4.3	7	35	2-Φ3.3	38	12.5	18	22.5	/	/
4V210-08	36	13.5	31.5	17	22	2-G1/4"	66.5	40	116.5	3	20	21.5	2-Φ4.3	7	35	2-Φ3.3	38	12.5	18	22.5	3-G1/4"	3
4V310-08	45	17.5	40	20	27	5-G1/4"	69	40	134.5	2.4	24	28	2-Φ4.3	6.5	40	2-Φ4.3	50	15	22	29	/	/
4V310-10	45	17.5	40	20	27	2-G3/8"	69	40	134.5	2.4	24	28	2-Φ4.3	6.5	40	2-Φ4.3	50	15	24	28	3-G3/8"	4
4V410-15	63	25.5	57	27	34	5-G1/2"	74	/	168	/	/	43	2-Φ4.3	7.5	50	2-Φ4.3	72	21	36	39	/	4

Overall Dimensions

4V120-420

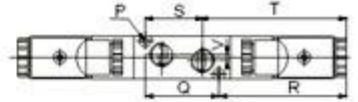
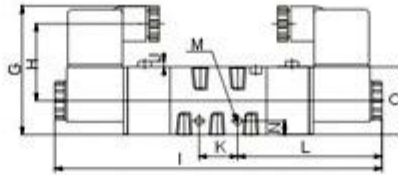
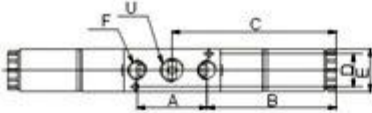

Dimension Sheet

Model	A	B	C	D	E	F	G	H	I	J	K	L	M	N	O	P	Q	R	S	T	U	V
4V120-M5	27	56.3	69.8	13	18	5-M5x0.8	53.5	32.5	139.6	2.5	14	62.8	2-Φ3.3	4	27	2-Φ3.3	30	54.8	14.1	62.8	/	/
4V120-06	28	56	69.8	13	18	5-G1/8"	53.5	32.5	139.6	2.5	14	62.8	2-Φ3.3	4	27	2-Φ3.3	30	54.8	16	62.8	2	3
4V220-06	36	67	85	17	22	5-G1/8"	66.5	40	169.8	3	20	75	2-Φ4.3	7	35	2-Φ3	38	66	18	76	/	/
4V220-08	36	67	85	17	22	2-G1/4"	66.5	40	169.8	3	20	75	2-Φ4.3	7	35	2-Φ3.2	38	66	21	74.4	3-G1/4"	3
4V320-08	45	71.9	94.4	20	27	5-G1/4"	69	40	188.8	2.4	24	82.4	2-Φ4.3	6.5	40	2-Φ4.3	50	69.4	22	83.4	/	/
4V320-10	45	71.9	94.4	20	27	2-G3/8"	69	40	188.8	2.4	24	82.4	2-Φ4.3	6.5	40	2-Φ4.3	50	69.4	24	82.4	3-G3/8"	4
4V420-15	63	79.5	111	27	34	5-G1/8"	74	/	/	/	28	97	2-Φ5.5	7.5	50	2-Φ4.3	72	75	36	93	/	4

Overall Dimensions

4A130-430C/P/E

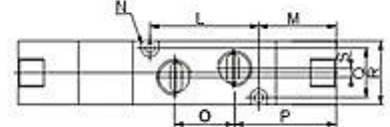
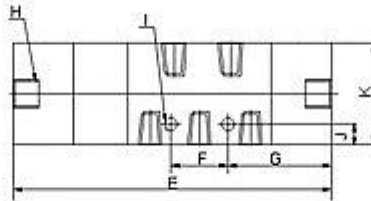
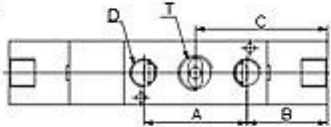
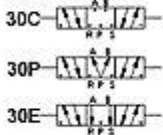

Dimension Sheet

Model	A	B	C	D	E	F	G	H	I	J	K	L	M	N	O	P	Q	R	S	T	U	V
4V130-M5	27	56.3	69.8	13	18	5-M5x0.8	53.5	32.5	154.6	2.5	14	62.8	2-Φ3.3	4	27	2-Φ3.3	30	54.8	14	62.8	/	/
4V130-06	28	56	69.8	13	18	5-G1/8"	53.5	32.5	154.6	2.5	14	62.8	2-Φ3.3	4	27	2-Φ3.3	30	54.8	16	62	2	3
4V230-06	36	67	84.9	17	22	5-G1/8"	66.5	40	189	3	20	75	2-Φ3.2	7	35	2-Φ3.2	38	65.9	18	75.9	/	/
4V230-08	36	67	84.9	17	22	2-G1/4"	66.5	40	189	3	20	75	2-Φ3.2	7	35	2-Φ3.2	38	65.9	21	74.4	3-G1/4"	3
4V330-08	45	71.9	94.4	20	27	5-G1/4"	69	40	208	2.4	24	82.4	2-Φ4.3	6.5	40	2-Φ4.3	50	69.4	22	83.4	/	/
4V330-10	45	71.9	94.4	20	27	2-G3/8"	69	40	207.8	2.4	24	82.4	2-Φ4.3	6.5	40	2-Φ4.3	50	69.4	24	82.4	3-G3/8"	4
4V430-15	63	79.5	111	27	34	5-G1/2"	74	/	/	/	28	97	2-Φ4.3	7.5	50	2-Φ4.3	72	75	36	93	/	4

Overall Dimensions

4A110-410

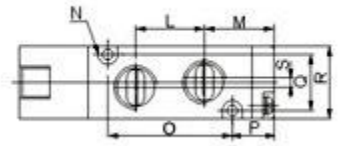
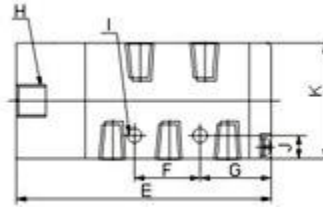
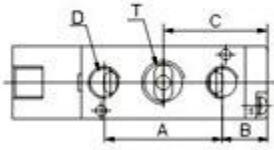

Dimension Sheet

Model	A	B	C	D	E	F	G	H	I	J	K	L	M	N	O	P	Q	R	S	T
4A110-M5	27	14.5	28	5-M5x0.8	68.7	14	21	G1/8"	2-Φ3.3	4	27	30	13	2-Φ3.3	21	14	13	18	/	/
4A110-06	28	14.2	28.2	5-G1/8"	68.7	14	21	G1/8"	2-Φ3.3	4	27	30	13	2-Φ3.3	20.2	16	13	18	3	2
4A210-06	36	13.5	31.5	5-G1/8"	77.7	20	21.5	G1/8"	2-Φ4.3	7	35	38	12.5	2-Φ3.2	22.5	18	17	22	/	/
4A210-08	36	13.5	31.7	2-G1/4"	77.7	20	21.5	G1/8"	2-Φ4.3	7	35	38	12.5	2-Φ3.2	21	21	17	22	3	3-G1/4"
4A310-08	45	17.5	40	5-G1/4"	95.5	24	28	G1/8"	2-Φ4.3	6.5	40	50	15	2-Φ4.3	29	22	20	27	/	/
4A310-10	45	17.5	40	2-G3/8"	95.5	24	28	G1/8"	2-Φ4.3	6.5	40	50	15	2-Φ4.3	28	24	20	27	4	3-G3/8"
4A410-15	63	25.5	57	5-G1/2"	128	28	43	G1/8"	2-Φ5.5	7.5	50	72	21	2-Φ4.3	39	36	27	34	4	/

Overall Dimensions

4A120-420

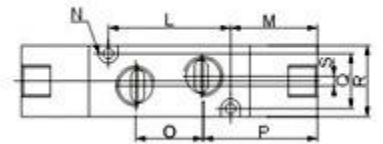
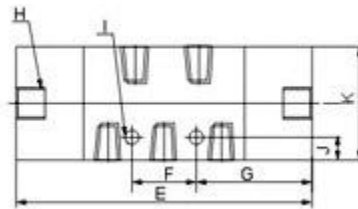
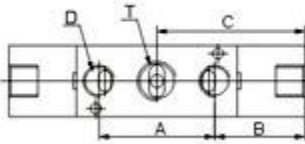

Dimension Sheet

Model	A	B	C	D	E	F	G	H	I	J	K	L	M	N	O	P	Q	R	S	T
4A120-M5	27	27	40.5	5-M5x0.8	81	14	33.5	2-G1/8"	2-Φ3.3	4	27	30	25.5	2-Φ3.3	21	33.5	13	18	/	/
4A120-06	28	26.5	40.5	5-G1/8"	81	14	33.5	2-G1/8"	2-Φ3.3	4	27	30	25.5	2-Φ3.3	20.2	32.5	13	18	3	2
4A220-06	36	28	46	5-G1/8"	92	20	36	2-G1/8"	2-Φ4.3	7	35	38	27	2-Φ3.2	22.5	37	17	22	/	/
4A220-08	36	28	46	2-G1/4"	92	20	36	2-G1/8"	2-Φ4.3	7	35	38	27	2-Φ3.2	21	35.5	17	22	3	3-G1/4"
4A320-08	45	33	55.5	5-G1/4"	111	24	43.5	2-G1/8"	2-Φ4.3	6.5	40	50	30.5	2-Φ4.3	29	44.5	20	27	/	/
4A320-10	45	33	55.5	2-G3/8"	111	24	43.5	2-G1/8"	2-Φ4.3	6.5	40	50	30.5	2-Φ4.3	28	43.5	20	27	4	3-G3/8"
4A420-15	63	39.5	71	5-G1/2"	142	28	57	2-G1/8"	2-Φ5.5	7.5	50	72	35	2-Φ4.3	39	53	27	34	4	/

Overall Dimensions

4A130-430C/P/E

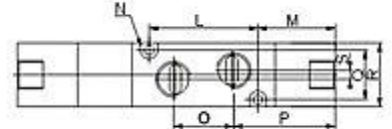
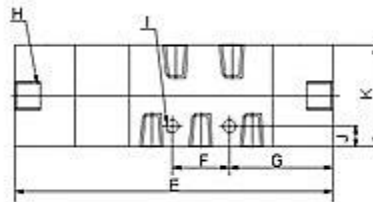
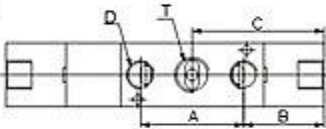
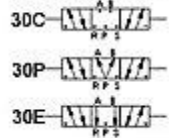

Dimension Sheet

Model	A	B	C	D	E	F	G	H	I	J	K	L	M	N	O	P	Q	R	S	T	U	V
4V130-M5	27	56.3	69.8	13	18	5-M5x0.8	53.5	32.5	154.6	2.5	14	62.8	2-Φ3.3	4	27	2-Φ3.3	30	54.8	14	62.8	/	/
4V130-06	28	56	69.8	13	18	5-G1/8"	53.5	32.5	154.6	2.5	14	62.8	2-Φ3.3	4	27	2-Φ3.3	30	54.8	16	62	2	3
4V230-06	36	67	84.9	17	22	5-G1/8"	66.5	40	189	3	20	75	2-Φ3.2	7	35	2-Φ3.2	38	65.9	18	75.9	/	/
4V230-08	36	67	84.9	17	22	2-G1/4"	66.5	40	189	3	20	75	2-Φ3.2	7	35	2-Φ3.2	38	65.9	21	74.4	3-G1/4"	3
4V330-08	45	71.9	94.4	20	27	5-G1/4"	69	40	208	2.4	24	82.4	2-Φ4.3	6.5	40	2-Φ4.3	50	69.4	22	83.4	/	/
4V330-10	45	71.9	94.4	20	27	2-G3/8"	69	40	207.8	2.4	24	82.4	2-Φ4.3	6.5	40	2-Φ4.3	50	69.4	24	82.4	3-G3/8"	4
4V430-15	63	79.5	111	27	34	5-G1/2"	74	/	/	/	28	97	2-Φ4.3	7.5	50	2-Φ4.3	72	75	36	93	/	4

3V Series Solenoid Valve, 3A Series Pneumatic Control Valve



Ordering Code

4V	2	10	—	06	□	—	AC220V	—	W
Specification Code 3V: Two(Three)-position Five-way Solenoid Valve 3A: Two (Three)-position Five-way Pneumatic Control Valve	Body Size 1:M5 and 1/8" Valve body 2: 1/8" and 1/4" Valve body 3: 1/4" and 3/8" Valve body 4: 1/2" Valve body	Coil and Places 10: Single-head Double-position 20: Double-head Double-position 30C: Double-head Three-position Close Type 30E: Double-head Three-position Exhaust Type 30P: Double-head Three-position Pressure Type		Port Size M5:M5×0.8 06: G1/8" 08: G1/4" 10: G3/8"	Port connection and Initial State Blank: Pipe Connection Type NC: Two-position Three-way Normal Close Type NO: Two-position Three-way Normal Open Type		Standard Voltage DC12V DC24V AC24V 50Hz/60Hz AC110V 50Hz/60Hz AC220V 50Hz/60Hz AC380V 50Hz/60Hz		Wiring Form Blank: standard Connector LD: Brown with Lighting Connector LD1: White with Lighting Connector W: Lead Wire Type

Internal structure

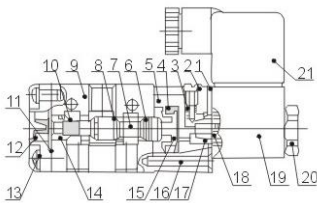

3V110-410

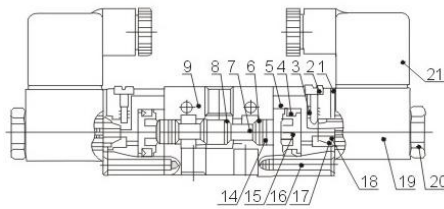

3V120-420

NO	Designation	NO	Designation	NO	Designation
1	Washer	8	O-Ring	15	Piston
2	Pin	9	Body	16	Screw
3	Spring	10	Spring	17	O-Ring
4	O-Ring	11	Seal	18	Active Amature
5	Body	12	End Cap	19	Coil
6	O-Ring	13	Screw	20	Nut
7	Spool	14	Wearing	21	Connector

Specification

Model	3V110-410	3V120-420	3A110-410	3A120-420
Position and Way NO.		Two-position Three-way		
Working Medium		40 Micron Filtered Air		
Motion Pattern		Inner Guide Type		
Working-Pressure		0.15~0.8MPa (22~116psi)		
Max.Pressure Resistance		1.2MPa (174psi)		
Operating Temperature		5~50°C		
Voltage Range		±10%		
Power Consumption		AC:4.5VA DC:3W		
Insulation & Protection Class		F Class.IP65		
Electrical entry		Lead Wire or Connector type		
Highest Action Frequency		5 Cycle / Second		
Response time		0.05 Second		

Overall Dimensions

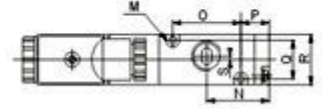
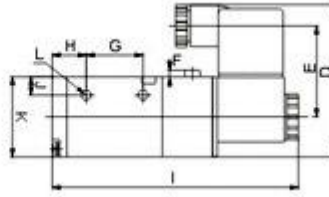
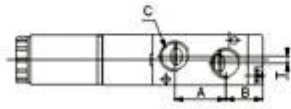
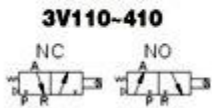

Model	A	B	C	D	E	F	G	H	I	J	K	L	M	N	O	P	Q	R	S	T
3V110-M5	16	14	3-M5	53.5	32.5	2.5	21	12	85.8	7.7	27	2-Φ 3.3	2-Φ 3.3	23	19	12.5	13	18	/	/
3V110-06	16	14	3-G1/8"	53.5	32.5	2.5	21	12	85.8	7.7	27	2-Φ 3.3	2-Φ 3.3	23	19	12.5	13	18	1	1
3V210-06	18	21	3-G1/8"	66.5	40	3	25	15	111.5	8	35	2-Φ 3.3	2-Φ 3.2	31	33	12.5	17	22	1.5	1.5
3V210-08	18	21	3-G1/4"	66.5	40	3	25	15	111.5	8	35	2-Φ 3.3	2-Φ 3.2	31	33	12.5	17	22	1.5	1.5
3V310-08	24	20.5	3-G1/4"	69	40	2.4	30	17.5	119.5	10.5	40	2-Φ 4.3	2-Φ 4.3	32.5	35	15	20	27	/	/
3V310-10	24	20.5	3-G3/8"	69	40	2.4	30	17.5	119.4	10.5	40	2-Φ 4.3	2-Φ 4.3	32.5	35	15	20	27	/	/
3V410-15	31.5	25.5	3-G1/4"	74	/	/	51	15.5	137	115	50	2-Φ 4.3	2-Φ 4.3	41.5	/	/	/	/	2	2

Dimension Sheet

3V120-420

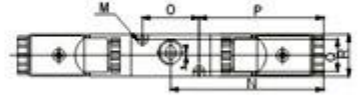
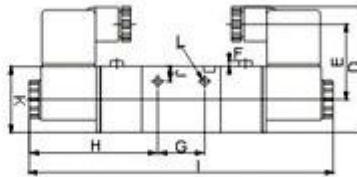
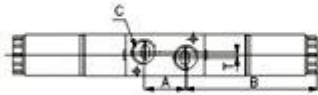
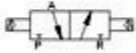

Model	A	B	C	D	E	F	G	H	I	J	K	L	M	N	O	P	Q	R
3A120-M5	16	26.5	3-M5	G1/8"	69	21	24	2-Φ 3.3	7.7	27	2-Φ 3.3	19	12.5	34.5	13	18	/	/
3A120-06	16	26.5	3-G1/8"	G1/8"	69	21	24	2-Φ 3.3	7.7	27	2-Φ 3.3	19	12.5	34.5	13	18	1	2
3A220-06	22.5	35.5	3-G1/8"	2-G1/8"	84	25	29.5	2-Φ 3.3	8	35	2-Φ 3.3	30	27	45.5	17	22	1.5	/
3A220-08	22.5	35.5	3-G1/4"	2-G1/8"	84	25	29.5	2-Φ 3.3	8	35	2-Φ 3.3	30	27	45.5	17	22	1.5	3
3A320-08	24	24	3-G1/4"	2-G1/8"	96	30	33	2-Φ 4.3	10.5	40	2-Φ 4.3	35	30.5	48	20	27	/	/
3A320-10	24	24	3-G3/8"	2-G1/8"	96	30	33	2-Φ 4.3	10.5	40	2-Φ 4.3	35	30.5	48	20	27	/	/
3A420-15	31.5	31.5	3-G1/4"	2-G1/8"	/	51	/	2-Φ 4.3	11.5	50	2-Φ 4.3	/	/	55	27	34	2	/

Overall Dimensions

Dimension Sheet

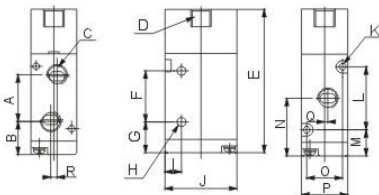

Model	A	B	C	D	E	F	G	H	I	J	K	L	M	N	O	P	Q	R
3A110-M5	16	14	3-M5	G1/8"	56.5	21	11.5	2-Φ 3.3	7.7	27	2-Φ 3.3	19	12.5	23	13	18	/	/
3A110-06	16	14	3-G1/8"	G1/8"	56.5	21	11.5	2-Φ 3.3	7.7	27	2-Φ 3.3	19	12.5	23	13	18	1	2
3A210-06	22.5	16	3-G1/8"	G1/8"	70	25	15	2-Φ 3.3	8	35	2-Φ 3.3	30	12.5	27.5	17	22	1.5	/
3A210-08	22.5	16	3-G1/4"	G1/8"	70	25	15	2-Φ 3.3	8	35	2-Φ 3.3	30	12.5	27.5	17	22	1.5	3
3A310-08	24	20.5	3-G1/4"	G1/8"	80.5	30	17.5	2-Φ 4.3	10.5	40	2-Φ 4.3	35	15	32.5	20	27	/	/
3A310-10	24	20.5	3-G3/8"	G1/8"	80.5	30	17.5	2-Φ 4.3	10.5	40	2-Φ 4.3	35	15	32.5	20	27	/	/
3A410-15	31.5	25.5	3-G1/4"	G1/8"	/	51	15.5	2-Φ 4.3	11.5	50	2-Φ 4.3	/	/	41.5	27	34	2	/

Overall Dimensions

Dimension Sheet

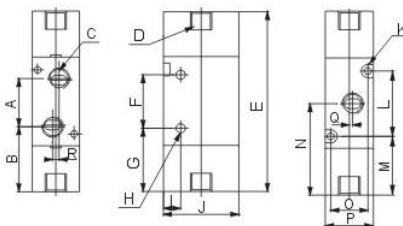

Model	A	B	C	D	E	F	G	H	I	J	K	L	M	N	O	P	Q	R
3A120-M5	16	26.5	3-M5	G1/8"	69	21	24	2-Φ 3.3	7.7	27	2-Φ 3.3	19	12.5	34.5	13	18	/	/
3A120-06	16	26.5	3-G1/8"	G1/8"	69	21	24	2-Φ 3.3	7.7	27	2-Φ 3.3	19	12.5	34.5	13	18	1	2
3A220-06	22.5	35.5	3-G1/8"	2-G1/8"	84	25	29.5	2-Φ 3.3	8	35	2-Φ 3.3	30	27	45.5	17	22	1.5	/
3A220-08	22.5	35.5	3-G1/4"	2-G1/8"	84	25	29.5	2-Φ 3.3	8	35	2-Φ 3.3	30	27	45.5	17	22	1.5	3
3A320-08	24	24	3-G1/4"	2-G1/8"	96	30	33	2-Φ 4.3	10.5	40	2-Φ 4.3	35	30.5	48	20	27	/	/
3A320-10	24	24	3-G3/8"	2-G1/8"	96	30	33	2-Φ 4.3	10.5	40	2-Φ 4.3	35	30.5	48	20	27	/	/
3A420-15	31.5	31.5	3-G1/4"	2-G1/8"	/	51	/	2-Φ 4.3	11.5	50	2-Φ 4.3	/	/	55	27	34	2	/

Price



MODEL	PRICE
3V210-06	\$35.52
3V210-08	\$35.52



MODEL	PRICE
3V310-08	\$35.52



MODEL	PRICE
4V120-06	\$67.52



MODEL	PRICE
4V210-08	\$35.52
4V310-08	\$51.60



MODEL	PRICE
4V220-06	\$58.72
4V220-08	\$58.72
4V320-08	\$74.64

Base For 4V, 4A Series Valve

Base Ordering Code



100M

□ F

Specification Code

100M:Base for 100 Series Use
 200M:Base for 200 Series Use
 300M:Base for 300 Series Use
 400M:Base for 400 Series Use

Joint Base Number

100M:Wantonly Joint
 200M:Wantonly Joint
 300M:Wantonly Joint
 400M:Wantonly Joint

Overall Dimensions

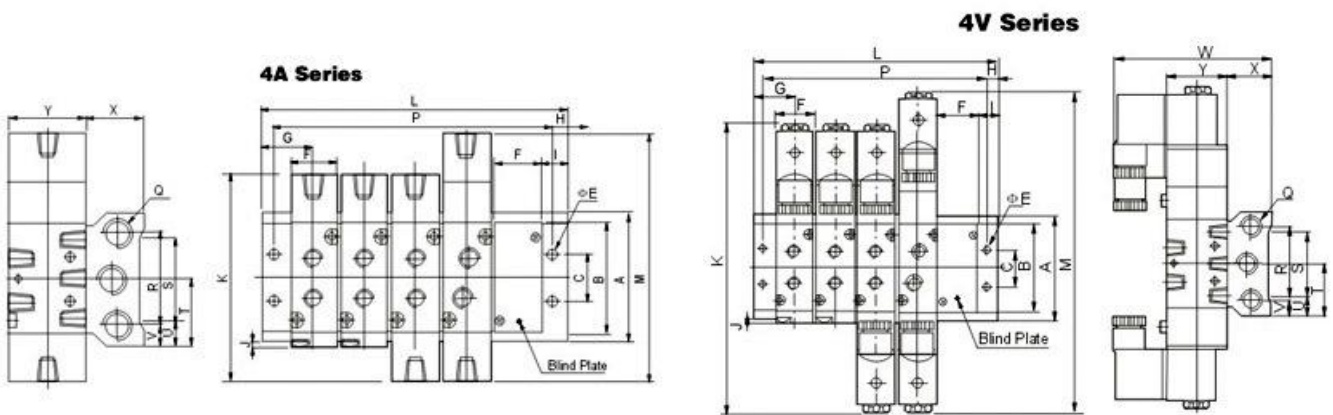

Dimension Sheet (4A Series)

Model	A	B	C	E	F	G	H	I	J	K	L															
											1F	2F	3F	4F	5F	6F	7F	8F	9F	10F	11F	12F	13F	14F	15F	16F
100M-□F	58	43.2	20	4.5	18.3	19	5	10	0.8	139.4	38	57	76	95	114	133	152	171	190	209	228	247	266	285	304	323
200M-□F	61	50.7	21	4.5	22.4	23	6	12	1.2	170	46	69	92	115	138	161	184	207	230	253	276	299	322	345	368	391
300M-□F	75	64.8	26	4.5	27.3	27	6	13.5	2.5	188.8	54	82	110	138	166	194	22	250	278	306	334	362	-	-	-	-
400M-□F	104	94.5	32	5.5	34.3	31.5	7	14.5	5	221.8	63	98	133	168	203	238	273	-	-	-	-	-	-	-	-	-

Model	M	P																Q	R	S	T	U	V	W	X	Y
		1F	2F	3F	4F	5F	6F	7F	8F	9F	10F	11F	12F	13F	14F	15F	16F									
100M-□F	154.5	28	47	66	85	104	123	142	161	180	199	218	237	256	275	294	313	G1/4"	40	30	29	14	9	79	25	27
200M-□F	189	34	57	80	103	126	149	172	195	218	241	264	287	310	333	356	379	G1/4"	43	32	30.5	14.5	9	93	26	35
300M-□F	208	42	70	98	126	154	182	210	238	266	294	322	350	-	-	-	-	G3/8"	53	48	37.5	13.5	11	99.5	30	40
400M-□F	243	49	84	119	154	189	224	259	-	-	-	-	-	-	-	-	-	G1/2"	68	67	52	18.5	18	112.5	38	50

Dimension Sheet (4V Series)

Model	A	B	C	E	F	G	H	I	J	K	L															
											1F	2F	3F	4F	5F	6F	7F	8F	9F	10F	11F	12F	13F	14F	15F	16F
100M-□F	58	43.2	20	4.5	18.3	19	5	10	0.8	81	38	57	76	95	114	133	152	171	190	209	228	247	266	285	304	323
200M-□F	61	50.7	21	4.5	22.4	23	6	12	1.2	92	46	69	92	115	138	161	184	207	230	253	276	299	322	345	368	391
300M-□F	75	64.8	26	4.5	27.3	27	6	13.5	2.5	111	54	82	110	138	166	194	22	250	278	306	334	362	-	-	-	-
400M-□F	104	94.5	32	5.5	34.3	31.5	7	14.5	5	142	63	98	133	168	203	238	273	-	-	-	-	-	-	-	-	

Model	M	P																Q	R	S	T	U	V	X	Y
		1F	2F	3F	4F	5F	6F	7F	8F	9F	10F	11F	12F	13F	14F	15F	16F								
100M-□F	96	28	47	66	85	104	123	142	161	180	199	218	237	256	275	294	313	G1/4"	40	30	29	14	9	25	27
200M-□F	111	34	57	80	103	126	149	172	195	218	241	264	287	310	333	356	379	G1/4"	43	32	30.5	14.5	9	26	35
300M-□F	130	42	70	98	126	154	182	210	238	266	294	322	350	-	-	-	-	G3/8"	53	48	37.5	13.5	11	30	40
400M-□F	163	49	84	119	154	189	224	259	-	-	-	-	-	-	-	-	-	G1/2"	68	67	52	18.5	18	38	50

Price



MODEL	PRICE
100M-3F	\$14.16
100M-4F	\$18.88
100M-6F	\$28.32
200M-3F	\$14.16
200M-4F	\$18.18
200M-6F	\$28.32
300M-3F	\$22.56
300M-4F	\$30.08
300M-6F	\$45.12

Base For 4M Series Valve



Blind Plate Ordering Code

100M

Specification Code
 100M:For 100 Series Use
 200M:For 200 Series Use
 300M:For 300 Series Use
 400M:For 400 Series Use

B

Blind Plate Code
 B:Base Purposed
 Blind Plate

Blind plate Operating Instructions:
 When base quantity is more than solenoid (pneumatic) valve quantity, use blind plate to seal the remaining valve base, and then change it if add extra solenoid (pneumatic) valve.

Price

MODEL	PRICE
100M-B	\$2.88
200M-B	\$3.92
300M-B	\$3.92

MSV Series Mechanical Valve



MSV98522-EB

MSV98522-PB

MSV98522-TB

MSV98522-LB

MSV98522-PP

MSV98522-PPL

MSV98522-R

Ordering Code

Specification

MSV	86	32	1	R
Specification Code Mechanical Valve	Series Code 86 Series 98 Series	Position and Way Number 32: Two-position Three-way 52: Two-position Five-way	Port Size 1: G1/8" 2: G1/4"	Button type Blank: Normal Type R: Roller Type TB: Selective Knob LB: Strengthened Knob PB: Large Round Boutton PP: Plat Round Button PPL: Convex Round Button EB: With Lock Button

Model	MSV86321	MSV86522	MSV98322
Working Medium	40 Micron Filtered Air		
Position and Way No.	Two-position Three-way	Two-position Five-way	Two position Three-way
Effective Section Area	12mm 2(CV=0.67)	16mm 2(CV=0.89)	16mm 2(CV=0.89)
Port Size	G1/8"	G1/4"	G1/4"
pressure Range	0~0.8Mpa (0~116psi)		
Temperature Range	0~60°C		

Overall Dimensions

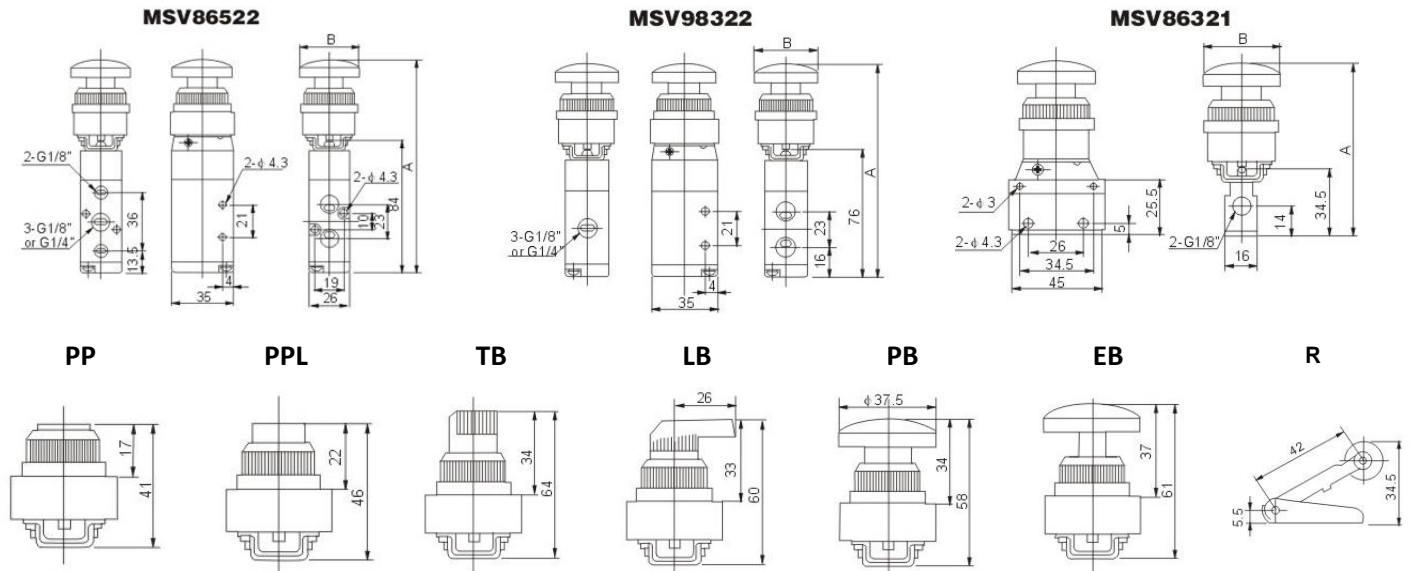

Dimension Sheet

Series	Symbol/Model	PP	PPL	LB	TB	EB	PB	R
MSV86522	A	114	119	133	136.5	134	131	107.5
	B	39.5	24.5	26.5	36.5	39.5	37.5	42.5
MSV98322	A	106	111	125	129.5	126	123	99.5
	B	39.5	24.5	26.5	36.5	39.5	37.5	42.5
MSV86321	A	66	71	85	88.5	86	83	59.5
	B	39.5	24.5	26.5	36.5	39.5	37.5	42.5

Price

MODEL	PRICE	MODEL	PRICE	MODEL	PRICE
MSV86521-TB	\$34.08	MSV86321-TB	\$18.72	MSV86321-PP	\$18.72
					